



SUVEDHA
Elegant



2 and 3 BHK Luxury Flats

Luxury Living

SUVEDHA Elegant

From a builder who shares the same dreams of the buyer

Suvedha Elegant is an irresistible living option from Suvedha Builders & Developers, who owns a legacy of providing quality construction and living innovations in some of the choicest localities in Bengaluru. With over three decades and projects, Suvedha has emerged as a synonym for quality, style and transparency. A rare blend of luxury, necessity and class- this is what makes every Suvedha project exceptional. The vision of Suvedha has been the same since beginning- straying away from convention and adding a new value and meaning to life.



Typical floor plan

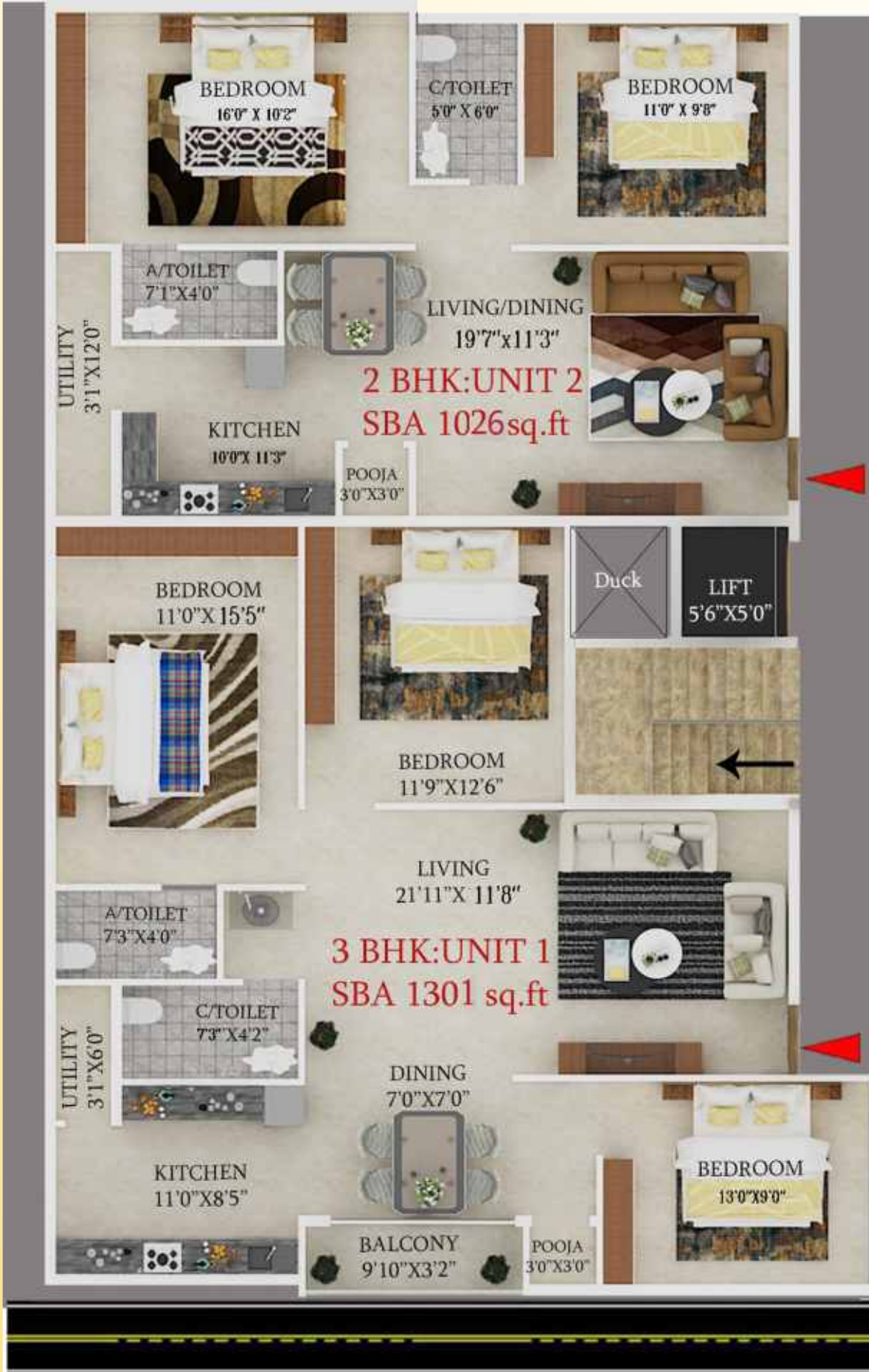

Night Vision



Isometric views



UNIT 01
North Facing
3 BHK Flats
Area : 1301 Sft.

Entrance

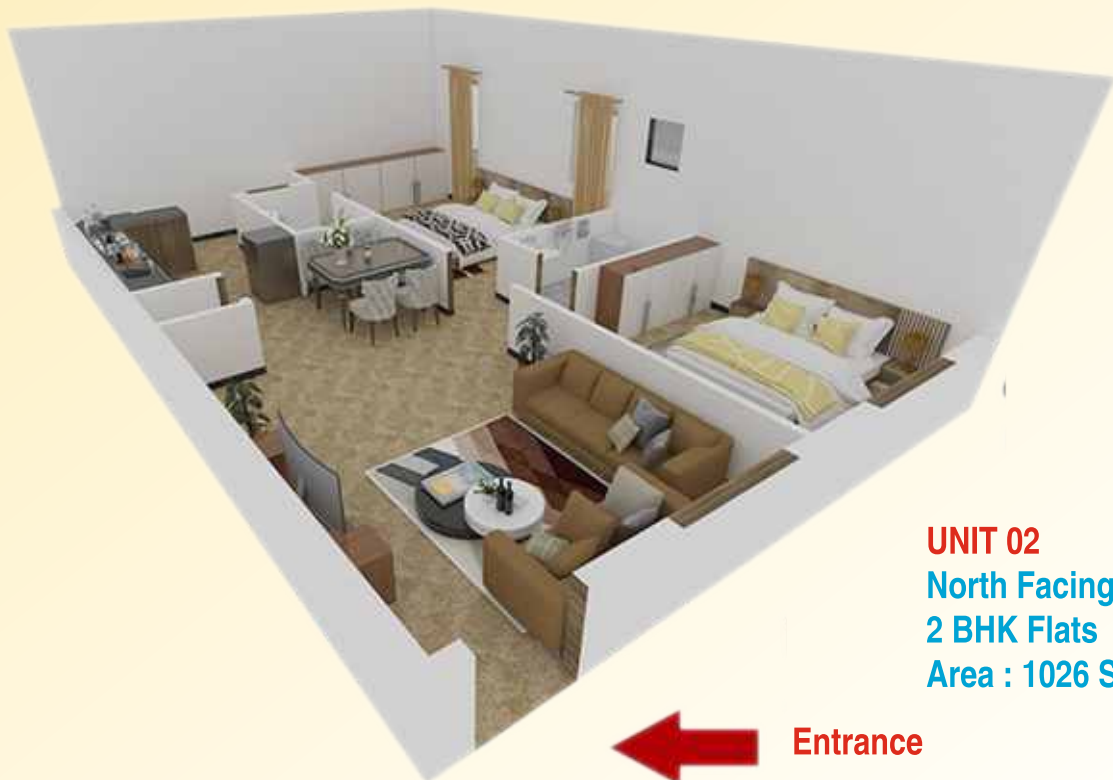

UNIT 02
North Facing
2 BHK Flats
Area : 1026 Sft.

Entrance

Car Parking Floor Plan



Specifications

STRUCTURE

R.C.C framed structure designed for zone II regulations.

WALLS

6" thick external walls and 4" thick internal walls of solid block masonry.

FLOORING

- Vitrified tile flooring for all flats.
- Staircase and lobbies with granite flooring.

DOORS

- Solid teak wood for main door.
- All other doors of flush wood with complete fittings.

WINDOWS

Sliding 3 track aluminium frame with MS grills.

KITCHEN

Stainless steel sink on 20 mm granite platform, 3' height dadoo above platform.

Power point provision for drinking water purifier, refrigerator, cooking range and exhaust fans.

TOILETS

Anti-skid ceramic tiles for flooring

Glazed tiles dadoo upto 7' height for toilet.

EWC and wash basins of ISI Make.

Quality CP fixtures & mixers.



PAINTING

Internal walls : Acrylic emulsion.

External walls : Weather proof Cement Based paint.

Doors & grills : Enamel paint.

Polish : Main door.

ELECTRICAL

- Finolex/equivalent FTLS copper wires.
- TV and telephone points in living and master bedrooms.
- Quality switches : Anchor/GM/equivalent

CAR PARKING

- Stilt level parking.

WATER SUPPLY

- Department supply & auxiliary, bore well supply.

Location Details

HOSPITAL

- Prashanth Hospitals : 2 kms
- Vinayaka Hospitals : 2 kms
- Meenakshi Hospital : 2 kms

SCHOOLS AND COLLEGES

- PES College : 2 kms
- JSS School : 2 kms
- Holy Saint School : 3 kms
- Auden Public School : 3 kms
- Little Flower Public School : 3 kms



Location Map



Architect :



Swan Design
Architect and interior Design

Srinivasanagar, BSK 1st Stage, Bengaluru - 560 050. Call : 77855 99971 / 72049 21463
www.swandesignarchitects.com Email : ram@swandesignarchitects.com



**SUVEDHA BUILDERS
& DEVELOPERS**

134, 3rd Floor, 6th 'C' Main, 4th Block,
Jayanagar, Bengaluru - 560 011.

Email : suvedhabuildersanddevelopers@gmail.com

For booking/details contact :

88843 78873

97417 77755

94495 04130

This brochure is purely conceptual. It is by no means a legal document.

The promoters, developers and the architects reserve the right to add, delete or alter any specifications, elevation or areas mentioned herein. If required.